

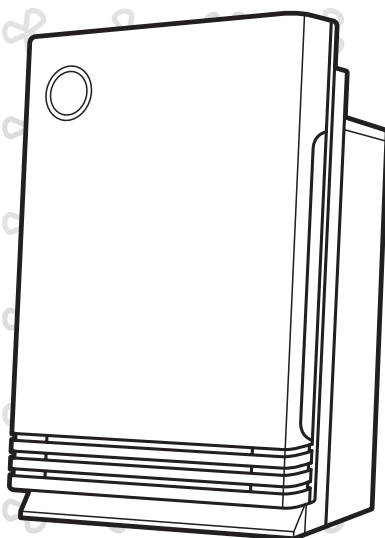

Coway Air Purifier AP-1511FHE

- This product is for domestic use only. It cannot be used in an overseas country where the power voltage is different.
- Warranty card is included in this user's manual.
- Read and save these instructions.



FEATURES

1. An Innovative ANTI-FLU HEPA™ Filter System

Coway's innovative ANTI-FLU HEPA™ captures micro particles and inactivates viruses up to 99.9%. The filter system has been optimized to quickly remove pollutants from the air.

* This appliance is not a medical device.



2. Advanced Deodorizing Ability

The deodorizing ability is improved by using AC deodorizing filter and RBD plasma antibacterial catalysis system which can eliminate not only harmful gases such as volatile organic compounds(VOCs), Ammonia, Aldehyde, but food and cigarette odors and so on.



3. Rhythm Cleaning System by Turbo Fan

Turbo fan increases the air flow rate and treats Indoor pollutants very quickly by rhythm cleaning system.

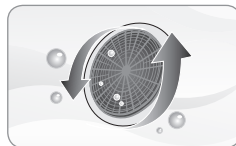

4. Automatic Operation by Dual Air Pollution Sensors

It allows you to check the status of indoor pollution through a dust and an odor sensor on a real-time basis. Besides, it minimizes electric consumption by automatically adjusting fan speed according to the indoor air pollution level.



5. Silent Operation at Night (Sleep Mode)

It is designed to be automatically switched to the silent operation by sensing light to provide a quiet and pleasant environment at the dark.



6. RBD Plasma System & Antibacterial Catalysis Filtering

We complexly applies RBD Plasma system and antibacterial catalysis filter which can remove harmful gas, and the floating bacteria. You can save the maintenance cost because a regular cleaning can extend the average life span of the filter, besides.

* RBD Plasma Catalysis System generates plasma which is the 4th condition of materials. RBD plasma system is made of the special silicon barrier for the stable electrical discharge, and gives full play to the genius in the removal of the bacteria mold.

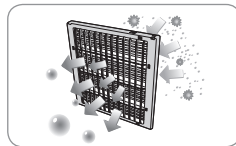

7. Anion Generation

A great amount of anions are generated, allowing users to enjoy forest-like air.



DEAR CUSTOMERS

Thank you for using the **Coway air purifier**.

Please read the User's Manual to use and maintain the product correctly.

If you encounter a problem while using the product, you may easily solve the problem by referring to the User's Manual. As this manual contains the product warranty card, please keep it in a safe place.

CONTENTS

FOR INFORMATION

- | 03 | **SAFETY INFORMATION**
 - Danger
 - Warning
 - Caution
- | 07 | **PARTS NAME**
- | 08 | **AIR PURIFIED PROCESS**

MAINTENANCE

- | 14 | **CLEANING METHOD**
 - Product
 - Filter
- | 17 | **FILTER REPLACEMENT**

HOW TO USE

- | 09 | **PREPARATIONS**
 - How to install filter
- | 10 | **INDICATORS AND CONTROLS**
- | 12 | **HOW TO USE**
- | 13 | **ADJUST PARTICLE SENSOR**

OTHERS

- | 18 | **TROUBLESHOOTING**
- | 19 | **SPECIFICATION**
- | 21 | **WARRANTY CARD**

SAFETY INFORMATION

The following information is for user safety that should be observed.

It is to ensure user safety and prevent property damage. Please read the precautions carefully and use the product correctly.



for 220 V - 240 V~ use only

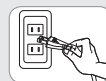

for 120 V~ use only

▲ Danger : Failing to follow the precautions below may result in serious injury or even death.

- Do not use a damaged power plug or loose electric outlet.
- Make sure to connect the power plug to a dedicated electric outlet for 220 V – 240 V~ 50 Hz/60 Hz.
- Do not move the product by pulling the power cord.
- Do not handle the power plug with a wet hand.
- Do not forcibly bend the power cord or run it under a heavy object to prevent it from being damaged or deformed.
- Do not plug in and plug out the power plug repeatedly.
- If the electric outlet is wet, carefully unplug the product and let the electric outlet completely dry before subsequent use.
- Unplug the product before repair, inspection, or parts replacement.
- Remove any dust or water from the power plug.
- Do not plug into an electric outlet or power strip that is being used by several other appliances. Use an electric outlet dedicated to the product.
- Unplug the product if it is not to be used for a long time.
- Do not attempt to repair or modify the power cord.
- If the power cord is damaged, do not replace the cord yourself. Call coway service center to have it replaced.
- Do not install the air purifier near a heating device.
- Do not place the product on top of an electrical appliance such as a heater or tv.

-
- Do not install the product in areas where moisture, dust or water (rainwater) is present.
 - Do not use the product in areas where flammable gases or combustible materials are used or stored.
 - Do not stick sharp objects such as a screw driver into the pollution sensor unit.
 - If the air purifier produces a strange noise, burning smell, or smoke, immediately remove the power plug from the electric outlet and call our service center.
 - Never put the product in water.
 - Do not spray any flammable materials such as insecticides or fragrances to the air inlet.
 - Do not disassemble, repair, or modify the product.
 - Do not place on top of the product any containers with water, medicine, food, any metallic objects, or any flammable material.
 - Unplug the product before you clean it.
 - Do not clean the product by applying water directly to the product or using benzene or thinner.

SAFETY INFORMATION

▲ Warning : Failing to follow the precautions below may result in considerable physical injury or property damage.

- Do not stick fingers or foreign objects into the air inlet or outlet.
- Do not let children hang on to the product or climb on it.
- When removing the front cover, exercise caution not to have part of you body or other objects stuck in the upper part of the product.
- This appliance is not intended for use by persons (including children) with reduced physical, sensory or mental capabilities, or lack of experience and knowledge, unless they have been given supervision or instruction concerning use of the appliance by a person responsible for their safety.
- Children should be supervised to ensure that they do not play with the appliance.
- This appliance can be used by children aged from 8 years and above.
- Cleaning and user maintenance shall not be made by children without supervision.

//////////

⚠ Caution : Failing to follow the precautions below may result in slight physical injury or property damage.

- Do not install the product on a sloped floor.
- Do not exert excessive force or shock on the product.
- When the product is in use, maintain a distance of at least 20 cm from walls or adjacent objects and 30 cm - 60 cm above the product.
- Install the product where no obstacles around the product block the circulation of air.
- Use the air purifier away from lighting devices or direct sunlight.
- Install the air purifier at least 2 m away from electronic products such as tv.
- Do not use the product in areas where it will be subjected to heavy smoke, odors, or oil.
- Do not use the air purifier in a location exposed to direct sunlight.
- Replace filters with new ones according to filter replacement cycles.
- Clean the pre-filter with water regularly and dry completely before use.
- Do not push or lean against this product, as it may topple over the product.

PARTS NAME

Front

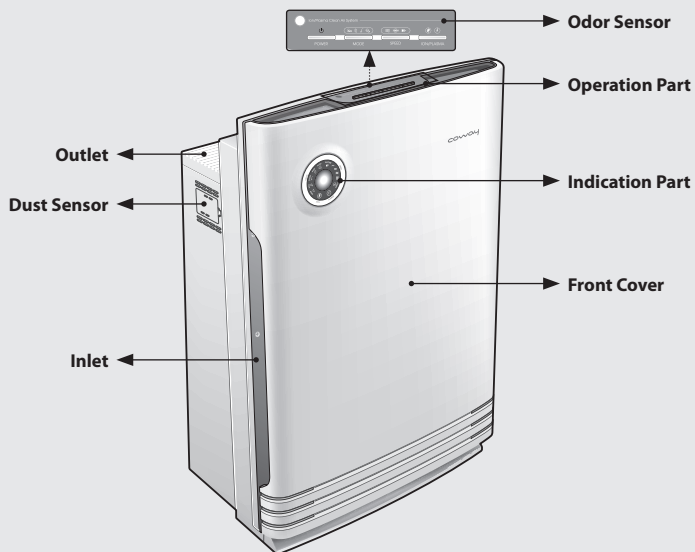

Rear

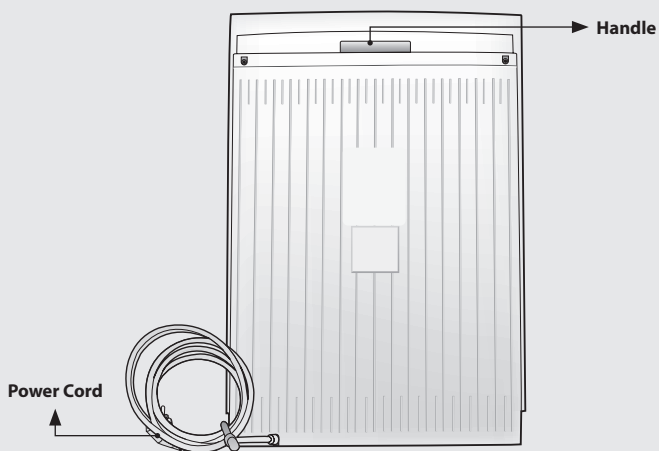

AIR PURIFICATION PROCESS

■ Pre-Filter

It is made of antibacterial material and filters comparatively large dust, hairs, pet dander, mold, and etc.

■ Legionella Filter

Legionella filter containing guano phosphate eliminates legionella and other bacteria. Common sources of legionella include cooling coil of air conditioner and a public water supply.

■ ANTI-FLU HEPA™ Filter

Coway's innovative ANTI-FLU HEPA™ captures micro particles and inactivates viruses up to 99.9 %. Natural substances from Ginkgo and Japanese sumac trees destroy the protein on the surface of viruses.

It also effectively removes fine dust and cigarette smoke while the antibacterial and anti-mold functions of the organic antibacterial materials eliminate germs and mold.

■ RBD Plasma Filter

It is the unique plasma system which can be very useful in not only the minimum of ozone generation but also the removal of the germ and mold.

■ Antibacterial Catalysis Filter

The filter is handled by the inorganic absorbent, the light catalysis that is useful to get rid of Formaldehyde such as bad smells, germs, harmful gas.

■ Activated Carbon Deodorization Filter

It is complexly treated by the light catalysis and the inorganic absorbent, so it can control the harmful gas, the bad smell, Formaldehyde which is the cause of Sick House Syndrome.

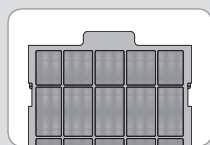

1. Pre Filter



2. Legionella Filter

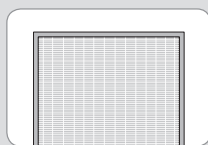

3. ANTI-FLU HEPA™ Filter

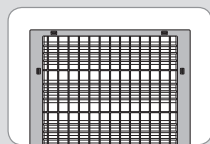

4. RBD Plasma Filter

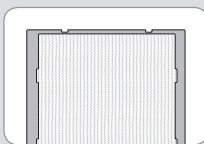

5. Antibacterial Catalysis Filter

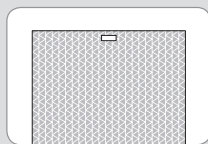

6. Activated Carbon Deodorization Filter

PREPARATIONS

Please check before use



The product is for 220 V – 240 V~ 50 Hz / 60 Hz only.

Make sure to connect the power plug to a grounded electric outlet (220 V – 240 V~ 50 Hz / 60 Hz) dedicated to the product.

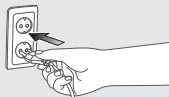

How to install filter



- Always remove filter wrapping before installation.
- The unit is for residential use and thus for indoor only.
- Remove power plug from the socket when not in use.
- Check front part of the filter when installing unit.

1. Open the front cover by pulling out the end part above the air inlet.

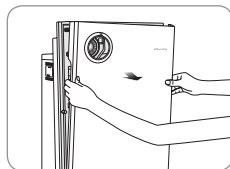

2. Please take out the filter by pushing the both hooks of the filter, and remove its packing sheet.

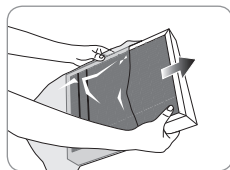
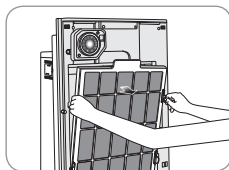

3. Please install filters according to the following order.
Activated carbon deodorization filter → Antibacterial catalysis filter → RBD plasma filter → ANTI-FLU HEPA™ filter → Legionella filter → Pre filter (Check the insert direction of filters and make the both hooks fixed into the unit.).

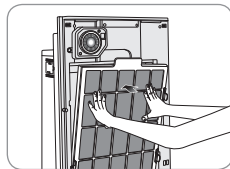

4. Please close the front cover.

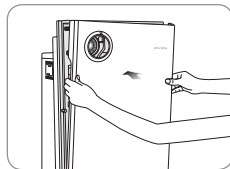

INDICATORS AND CONTROLS

Indication part

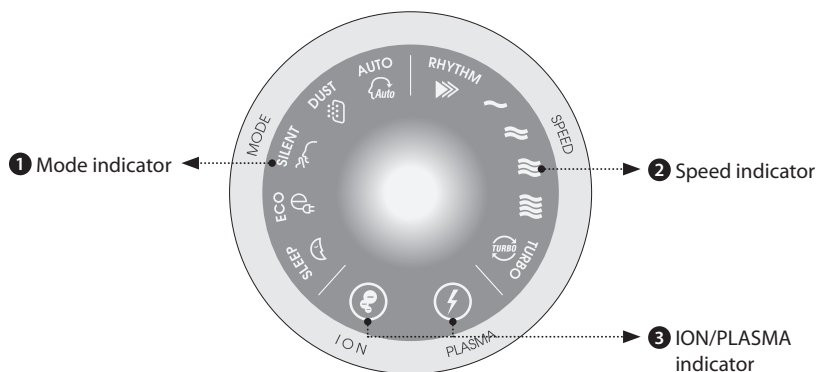

AUTO DUST SILENT ECO SLEEP



1 Mode indicator

By using the Mode button, it is possible to select the operation mode in 4 steps (Auto – Dust – Silent – Eco).

RHYTHM



TURBO



2 Speed indicator

By using the speed button, it is possible to select the airflow speed in 6 steps (Step1 – Step2 – Step3 – Step4 – Turbo – Rhythm).



3 ION/PLASMA indicator

By using the ION/PLASMA button, it is possible to select the operation mode.

INDICATORS AND CONTROLS

Operation part

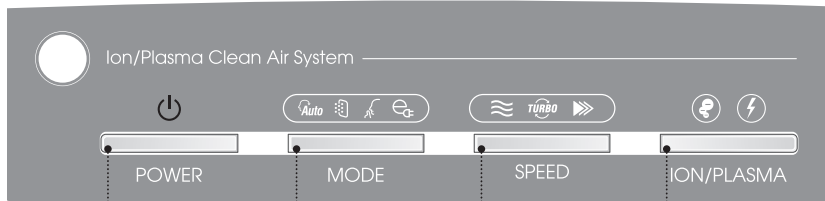

- 1** Power button **2** Mode button **3** Speed button **4** ION/PLASMA button



1 Power button

Use it to turn the product on/off.



2 Mode button

Use it to select the operation mode by pushing button. (Auto – Dust – Silent – Eco)



3 Speed button

Use it to select the desired airflow speed. Please use the 'Turbo' when the air is highly polluted.
(Step1 – Step2 – Step3 – Step4 – Turbo – Rhythm)



4 ION/PLASMA button

Use it to select the operation mode by pushing button.

HOW TO USE



Tips

- Before operating the product, connect the power plug to a dedicated electric outlet.
- Once the power is turned on, you will see the previously used operation mode, already set for you to use.

■ To select the mode

Press the mode button and then choose the desired mode.

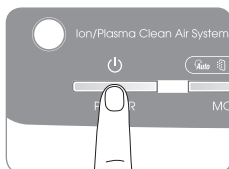

■ To select the airflow speed

Press the Speed button and then choose the desired airflow speed.

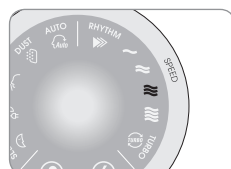
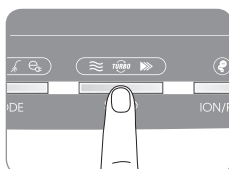

■ To select ION / PLASMA

Press the ION / PLASMA button and then choose the desired mode.

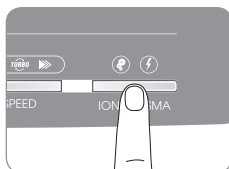

■ To operate the sleep mode (available only in Auto, Dust, Eco mode operation)

If the surroundings are dark for 3 minutes, the product automatically switches to sleep mode, lowering the airflow speed, noise, and electricity consumption. If the surroundings become bright again for 5 minutes or longer, the unit resumes normal operation. In sleep mode, all displays except the sleep indicator are turned off.



ADJUST PARTICLE SENSOR

When the product is shipped out, the pollution sensor is set to standard sensitivity. If the pollution level stays at the highest level after 2 hours of operation or stays at the lowest level for more than 1 hour when the air does not seem clean, users can adjust the sensitivity of the pollution sensor as follows.

How to adjust the sensitivity of the pollution sensor

- 1. Press both Mode and Speed button just over 2 seconds.

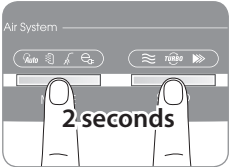

- 2. Adjust the sensitivity by pressing the mode button. The sensitivity of the sensor is displayed by blinking airflow speed indicator.

Sensitive	Standard	Insensitive
SPEED Step 1	SPEED Step 2 ~ 3	SPEED Step 4



- 3. After adjustment, press speed button when the sensitivity of the pollution sensor is set or automatically set when 5 seconds have passed in the setting mode.

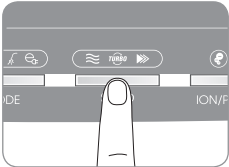

CLEANING METHOD



Tips

- Always unplug the air purifier before cleaning the product.
- Do not use detergents that contain organic solvents (solvent, thinner, etc), bleach, chlorine, or abrasives.
- Do not put the air purifier in water or spray water directly on it.

■ Cleaning the pollution sensor (every 2 months)

1. Open the pollution sensor cover on the left-hand side of the product. Clean the air inlet and outlet vent and then the pollution sensor with a soft brush or vacuum cleaner.

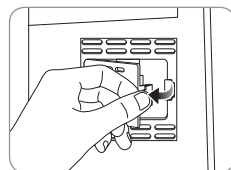
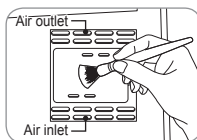

2. Wet a cotton swab lightly and clean the lens, dust inlet, and dust outlet. Clean them with a dry cotton swab to remove remaining moisture.

* Without regular cleaning, the performance of the pollution sensor deteriorates.

* The cleaning cycle differs depending on the operation environment.

When using the product in a dusty environment, clean the sensor more often.

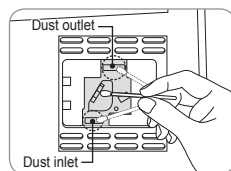

■ Cleaning the air inlet and outlet (every 2 months)

Clean the air inlet and outlet with a soft brush.

* Exercise caution not to have dust fall inside the air purifier.

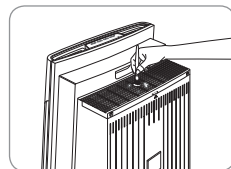

■ Cleaning the front cover

Separate the front cover from the product and remove the dust attached to the surface with a soft dry brush or cloth.

* Use lightly wet cloth if the contamination is serious but do not use abrasives.

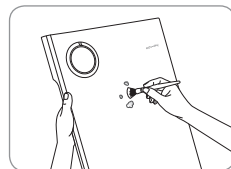

■ Cleaning the product body (every 2 ~ 4 weeks)

Use dry, soft cloth to clean the product.

* Use lightly wet cloth if the contamination is serious but do not use abrasives.



CLEANING METHOD



Tips

- Always unplug the power cord before cleaning the filter.
- The pre-filter is reusable after removing dust or cleaning it with water.
- If the pre-filter is not cleaned for a long time, the product performance may deteriorate.
- The HEPA filter are not reusable with cleaning. Never clean them with water.

■ Cleaning the pre-filter (every 2 ~ 4 weeks)

1. Open the front cover by pulling out the end part above the air inlet.

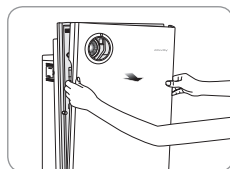

2. Take out the pre-filter by pulling out on the handles.
* To prevent dust from falling off, remove the filter carefully without exerting a shock.

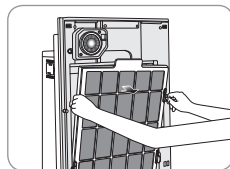

3. Clean the pre-filter with a vacuum cleaner or with water depending on the level of contamination.

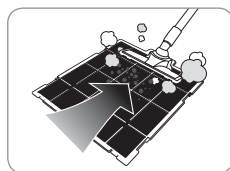

4. Install the pre-filter after removing the moisture completely.
Fit the front cover back to the product.
* When refitting the pre-filter to the product, fit it in the hook correctly.

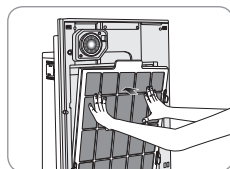

■ Anion Electrode Part Cleaning (Every 2months)

Get rid of dirties on the charged body and the electric discharge pin with soft brush of cotton swab after opening a ventilation grill with a screw driver. (Be careful not to drop the cotton swab into the unit.)

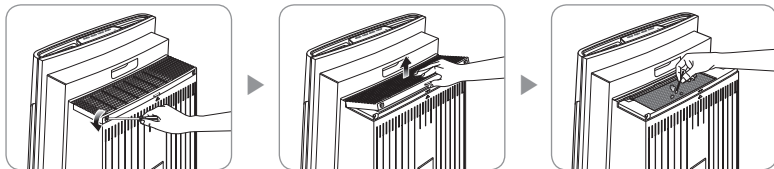

■ RBD Plasma Antibacterial Catalysis Filter

1. Open the front cover by pulling out the end part above the air inlet.

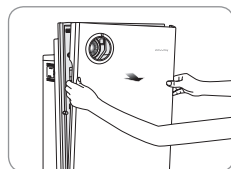

2. Take out the plasma antibacterial catalysis filter, and then divide the filter into two pieces by pushing both hooks of the filter.

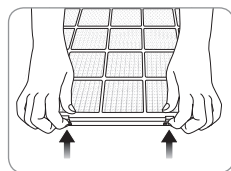
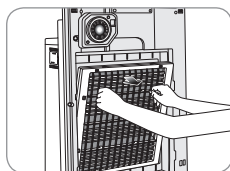

3. When you clean the RBD plasma filter, please wipe the tungsten wire, the dirties on the electrode with a wet cloth and then make it dry with a dry cloth.
 - * Never splash the water in the unit or soak it in water.
 - * Be careful about the down of the tungsten wire.
 - * Please completely dry, in case that the water gets into the inside of the filter. (If the inside is taken by water, please use after dry over 12 hours.)

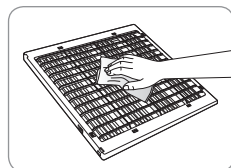

FILTER REPLACEMENT

How to replace filters

- Replace the filters referring to the descriptions about installing the filters on page 9.
- When you replace the filters, confirm that the 'front' sides of the filters are facing forward.
- To maintain optimal performance of the product, use original Coway filters.
- Always unplug the air purifier before replacing filters.

Filter cleaning and replacement cycles

Filter	cycles	method
Pre-filter	Every 2 ~ 4 weeks	Cleaning
Legionella filter	Every 4 ~ 6 months	Replacement
ANTI-FLU HEPA™ Filter	Every year	Replacement
RBD Plasma filter	Every 2 months	Cleaning
Antibacterial Catalysis filter	Every 6 months	Cleaning
	Every 2 years	Replacement
Activated carbon deodorization filter	Every 2 years	Replacement

Each service life is based on 24-hour use in AUTO mode.
The recommended filter replacement cycles may differ depending on the operating environment.

Replacing Filters

1. Open the front cover by pulling out the end part above the air inlet.
2. Separate filter that you want to replace from the filter case.
3. Put the filters in the unit with the opposite direction, and then close the cover after filter replacement.

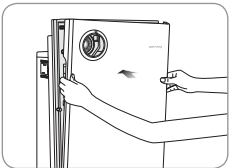
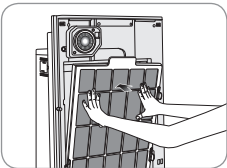
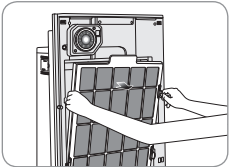
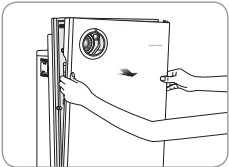

TROUBLESHOOTING

The air purifier may operate abnormally due to minor causes not because of the product malfunction but because of the fact that the user is not familiar with the product use. In such a case, problems can be solved easily even without the help from the Service Center by checking the following items. If you can't solve the problem after checking the following items, please call the Service Center.

Symptom	Check	Measures to take
No air is blowing.	• Is the power cord connected?	Connect the power cord to an electric outlet for 220 V – 240 V~ 50 Hz / 60 Hz.
	• Is the display part all turned off?	Press the power button and then select the desired function.
	• Isn't the power gone out?	Use the air purifier after the power comes back on.
The airflow speed does not change.	• Isn't it in Auto or Silent mode?	In the Auto and Silent mode, the airflow rate could not selected by hand-operating.
	• Isn't the room dark?	When in sleep mode, the airflow speed is fixed to the minimum level.
The airflow speed is significantly weaker than before.	• Isn't the filter cleaning or replacement time passed?	Check the filter cleaning and replacement cycles and then clean/replace the filter(s) if necessary.
A bad smell comes out of the air outlet.	• Isn't the filter cleaning or replacement time passed?	Check the filter cleaning and replacement cycles and then clean/replace the filter(s) if necessary.
The color of the pollution level indicator always stays the same.	• Isn't there dust on the pollution sensor's lens?	Clean the lens of the pollution sensor.
	• Does the pollution level keep indicating a high level?	Adjust the sensitivity of the pollution sensor to Insensitive or standard.
	• Does the pollution level keep indicating a low level?	Adjust the sensitivity of the pollution sensor to sensitive or standard.
The Plasma indicator blinks.	• Isn't the RBD Plasma filter systematically put in the unit?	Install the RBD Plasma filter on the unit after checking its formation.
	• Isn't the tungsten wire down?	Please request for A/S.
The pollution level indicator blinks.	• Request service or ask our service center.	
When other functional problems are detected.	• Check the symptoms, unplug the product, and then request service or ask service center.	

SPECIFICATION

Product specification	Air Purifier
Model	AP-1511FHE
Rated voltage	220 V – 240 V~ 50 Hz / 60 Hz
Phase	1
Power consumption	72 W
Product installation grade	Grade 2 device
Dust collection mode	Mechanical dust collection method(HEPA filter)
Safety feature	Power is shut down when the front cover is opened.
Installation place	Indoor use
Maximum volume of air	7.1 m ³ /min
Size	476 mm(W) × 565 mm(H) × 292 mm(D)
Weight	12 kg

► The specifications are subject to minor changes to improve the product performance.

MEMO

////////////////////////////////////

WARRANTY CARD OR WARRANTY LETTER
ONE YEAR LIMITED WARRANTY
AIR PURIFIER AP-1511FHE ("PRODUCT")

Model:

Serial Number:

Customer Name:

("OWNER")

Date of Purchase:

What This Warranty Covers:

Commencing with the date of purchase of the Product and continuing for a period of one year, if manufacturing defects in the Product cause the Product to not operate properly for its intended use, then subject to the exclusions, conditions, and limitations contained herein, COWAY at its sole option will repair or replace the Product.

Decisions as to the extent of repair or replacement required will be made solely by COWAY.

The remedy under this Warranty is available only for that portion of the Product exhibiting defects at the time of the warranty claim. The replacement Product as well as any remaining original Product will be warranted only for the original one year warranty period. This limited warranty applies only to Product used for an application specified by COWAY for the Product and applied in strict accordance with COWAY published specifications in effect at the time of application. IF PRODUCT IS USED FOR OTHER THAN ITS INTENDED PURPOSE, IT IS SOLD AS IS AND WITHOUT ANY EXPRESS OR IMPLIED WARRANTIES, INCLUDING OF MERCHANTABILITY OR FITNESS FOR A PARTICULAR PURPOSE.

What This Warranty Does Not Cover:

This Warranty warrants that the Product will be free from manufacturing defects which affect the ability of the Product to operate for its intended use; it is not a warranty that the Product will never require repairs or to undertake responsibilities, liabilities or obligations other than those specifically identified in the preceding section.

COWAY is not responsible or liable for personal injury or property damage of any kind, even if arising from a breach of this Warranty.

Limitations and Exclusions:

TO THE EXTENT PERMITTED BY APPLICABLE LAW, COWAY DISCLAIMS ANY OTHER WARRANTY EXPRESS OR IMPLIED, THAN THAT PROVIDED FOR HEREIN. THIS WARRANTY IS IN LIEU OF AND EXCLUDES ALL OTHER WARRANTIES, GUARANTEES, CONDITIONS AND REPRESENTATIONS, EXPRESS OR IMPLIED, ORAL OR WRITTEN, STATUTORY OR OTHERWISE, INCLUDING BUT NOT LIMITED TO ANY IMPLIED CONDITIONS OR WARRANTIES AS TO THE MERCHANTABILITY OR FITNESS FOR A PARTICULAR PURPOSE OF THE COWAY PRODUCT. SOME STATES DO NOT ALLOW LIMITATIONS ON HOW LONG AN IMPLIED WARRANTY LASTS, SO THE ABOVE LIMITATION MAY NOT APPLY TO YOU. COWAY DOES NOT AUTHORIZE ANY PERSON INCLUDING ITS REPRESENTATIVES, TO MAKE ANY REPRESENTATION OR TO OFFER ANY WARRANTY, CONDITION OR GUARANTY IN RESPECT OF THE PRODUCT OTHER THAN THIS WARRANTY. THIS LIMITED WARRANTY SHALL BE THE OWNER'S SOLE AND EXCLUSIVE REMEDY AGAINST COWAY AND COWAY SHALL NOT BE LIABLE FOR ANY CONSEQUENTIAL, EXEMPLARY, SPECIAL, INCIDENTAL OR OTHER DAMAGES INCLUDING, BUT NOT LIMITED TO, LOSS OF PROFITS, AND LOSS OF USE. INCIDENTAL, CONSEQUENTIAL AND EXEMPLARY DAMAGES SHALL NOT BE RECOVERABLE EVEN IF THE REMEDIES OR THE ACTIONS PROVIDED FOR IN THIS WARRANTY FAIL OF THEIR ESSENTIAL PURPOSE. SOME STATES DO NOT ALLOW THE EXCLUSION OR LIMITATION OF INCIDENTAL OR CONSEQUENTIAL DAMAGES, SO THE ABOVE LIMITATION OR EXCLUSION MAY NOT APPLY TO YOU. COWAY SHALL NOT BE LIABLE FOR ANY DAMAGES WHICH ARE BASED UPON NEGLIGENCE, BREACH OF WARRANTY, STRICT LIABILITY OR ANY OTHER LEGAL THEORY OF LIABILITY OTHER THAN THE EXCLUSIVE LIABILITY SET FORTH IN THIS WARRANTY.

Limitations on Implied Warranties:

Any implied warranty of merchantability or fitness for a particular purpose or use, shall be limited to the duration of the foregoing express written warranty.

Conditions of Warranty:

COWAY's continuing liability under this Warranty is conditioned upon the following :

- The defect or damage is not caused by or is the result of : abnormal use or conditions; improper storage, unauthorized modifications or repair; misuse, neglect, accident, alteration, improper installation or other acts that are not the fault of Coway or the manufacturer of the product or that are not covered by the manufacturer's warranty;
- The Product has not been altered, modified or repaired without prior written approval of COWAY;
- The OWNER has notified COWAY in writing of any failure of the Product covered by this Warranty within thirty (30) days following such failure;
- There has been no misuse, abuse or negligence with respect to the Product on the part of the OWNER.

Waiver:

COWAY's failure at any time to enforce or rely upon any of the terms or conditions stated herein shall not be construed to be a waiver of its rights hereunder.

Obtaining Warranty Service and OWNER'S Duties:

If the Product fails to operate for its intended purpose, then notify Coway or its Representative Agency within 48 hours or within the next business day after discovery of any defect in the Product. The OWNER must give written notice to COWAY no later than thirty (30) days after a defect is discovered or should by reasonable diligence have been discovered. Claims under this Warranty will require proof of purchase by the OWNER.

COWAY

Add : Coway co., Ltd.
136-23, Yugumagoksa-ro, Yugu-eup, Gongju-si,
Chungcheongnam-do, Korea
Tel. : 82-41-850-7879
Fax. : 82-41-841-7816

USA

Add : WOONGJIN COWAY USA, INC
4221 Wilshire Blvd. #210 Los Angeles, CA90010
Call center. : (213) 386-3033
Fax. : (213) 386-3032

THAILAND

Add : COWAY(THAILAND) CO., LTD.
No.75/104-106,38TH FL,OCEAN TOWER 2 BUILDING,
SOI SUKHUMVIT 19,KLONGTON NUA,WATTANA,
BANGKOK,THAILAND ZIP CODE:10110
HQ : 001-66-2-261-2610
Call center : 001-66-2-315-7578

MALAYSIA

Add: COWAY (M) SDN BHD
SUITE 6-3 & 6-4 LEVEL 6, WISMA UOAII
NO.21 JALAN PINANG 50450 KUALA LUMPUR
kuala Lumpur
Call center : 1-800-888-112

coway

www.coway.com